

## **VAL-AIR**

### **AIR COMPRESSORS**

---

All **Val-Air Compressors** are virtually soundless and are totally automatic. Each unit includes a tank pressure gauge, line pressure gauge, line pressure regulator, moisture trap/filter, safety-valve, air-intake filter and a handle for balanced carrying.

**VAL-AIR 50-24-AL**  
**½ HP, 6 GAL. TANK**  
**2.15 CFM FREE AIR**  
**84-114 PSI Op-PRESSURE**  
**SHIPPING WEIGHT: 65 LBS**  
**VOLTAGE: 110V-60/220-240**  
(no wheels, no cooling fan)

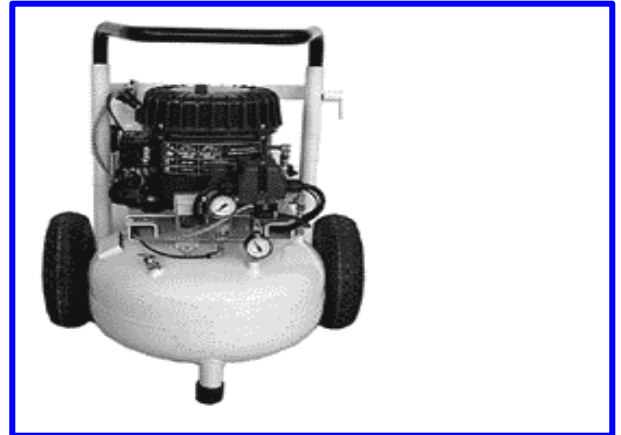

**VAL-AIR 100-24**  
**2 x ½ HP, 6 Gal. Tank**  
**4.3 CFM FREE AIR**  
**84-114 PSI Op-PRESSURE**  
**SHIPPING WEIGHT: 110 LBS**  
**VOLTAGE: 110 V-60/220-240**

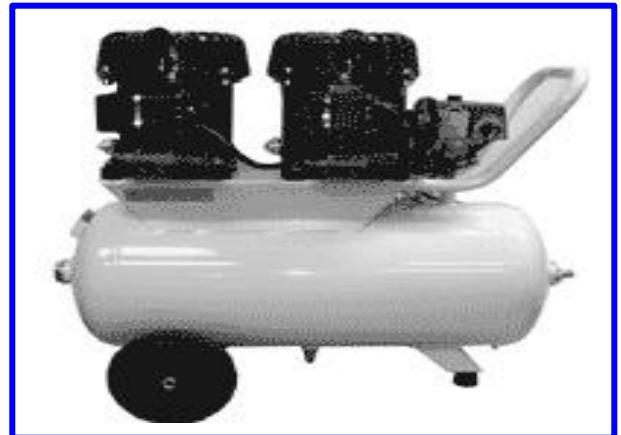

**VAL-AIR 150-50**  
**3 X ½ HP, 13 GAL. TANK**  
**6.45 CFM FREE AIR**  
**84-114 PSI Op-PRESSURE**  
**SHIPPING WEIGHT: 160 LBS**  
**VOLTAGE: 220 V-60/220-240**



## PARTS LIST

Part Number	Part Description	Part Number	Part Description
B0714	Bolt M8x50mm UNI 5739 ZB	C0077	Fitting Swivel-Connector M-M1/4"
C0004	Clip for Terminal Bloc	C0081	Handle Rubber
C0010	Fitting L M3/8"-F3/8"	C0083	Fitting M1/4"-M1/4" 80mm
C0011	Filter Air-Intake	C0088	Gauge Pressure 1/8"-rear
C0021	Drain Cock M1/8"	C0089	Fitting M1/4"-M1/4" 95mm
C0024	Plug for Oilfill	C0091	Cable Electric 230V 500mm
C0026	Gauge Pressure M1/8"-side 10 bar d=40mm	C0092	Fitting T M-F-F1/4"
C0028	Fitting Nipple 1/4"	C0093	Cover for Terminal Bloc
C0034	Strain Relief	C0094	Foot Rubber
C0037	Bolt M6x20mm UNI 5931	C0097	Foot Rubber
C0038	Fitting M1/4"-M1/4"	C0099	Bolt TE M6x20mm UNI 5739
C0039	Washer 5,3x10mm UNI 6592	C0100	Washer 8,4x16x1,5mm UNI 6592 ZB
C0040	Fitting Reduction M1/4"-F1/8"	C0101	Closing Band T2134 A
C0043	Bolt TE M6x10mm DIN 934	C0102	Cap Plastic Transparent
C0044	Handle Mod. 1080 135mm	C0103	Gasket Housing
C0045	Cable Electric 230V 600mm	C0105	Bolt M8x30mm
C0046	Valve Check M1/8"-F1/8"	C0106	Spacer
C0047	Fitting M5 d=6mm	C0108	Terminal-Bloc
C0048	Switch Pressure 4-P 230V MDR 2/11	C0109	Bracket for Capacitor
C0048-1	Cover to Switch Pressure C0048	C0110	Capacitor 230V 53-64 MFD
C0049	Plug M1/4"	C0111	Overload Protector 230V
C0051	Hose Nylon 6/4	C0112	Relay Starting 230V
C0061	Bolt M8x15mm	C0113	Bolt
C0062	Washer M10x20mm UNI 6592	C0114	Nut M8 UNI 5589
C0063	Fitting L M1/4"-F1/8"	C0115	Gasket Exhaust-Valve
C0064	Hose Air M1/8"-F1/4" 170mm	C0116	Valve Plate cpl.
C0065	Fitting "L"-Rotating M1/4"x6,3mm	C0117	Gasket Intake-Valve
C0067	Bolt TE M8x35mm UNI 5739	C0120	Washer Flat 8x24mm UNI 6593
C0068	Power Cord 230V Euro-Plug	C0124	Valve Safety 8 bar M1/4"
C0073	Hose Air M1/8"xF1/4" 235mm	C0126	Foot Rubber
C0076	Fitting L M1/4"-F1/4"	C0135	Kit Bracket for Mounting Motor
C0136	Plate for Mounting Motor	C0311	Gasket Pressure-Pipe
C0137XX	Tank 15lt vertical	C0312	Bolt for Top-Bearing
C0138	Drain Cock M1/4"	C0313	Bearing Top
C0143	Wheel Rubber d=150mm	C0314	Spring for Suspension
C0144XX	Tank 50-9D	C0315	Cover
C0146	Plug 1" F1/4"	C0316	Gasket to Cover
C0150	Fitting L M1/8"-F1/8"	C0317	Overload Protector 115V
C0151	Fitting M1/4"-M1/4" 60mm	C0320	Bolt to Stator
C0153	Valve Check M3/8"-M3/8"	C0321	Stator 230V
C0154	Washer Alum. d=6,2x10mm	C0322	Kit Motor Parts excl. Stator
C0156	Fitting Manifold 4xF1/4"-1xF1/8	C0323	Valve Intake
C0164	Filter Regulator WI	C0324	Valve Exhaust
C0164-1	Pressure Bowl WI	C0325	Relay Starting 115V
C0164-2	Filter Element WI	C0331	Kit Motor-Parts cpl. 115V w/o Housing
C0164-4	Filter Regulator SMC	C0332	Stator 115V
C0164-5	Pressure Bowl SMC	C0334	Fitting L M1/8"-F1/8"
C0164-6	Filter Element SMC	C0335	Hose Air F1/8"-F1/8" 140mm

<b>C0164-7</b>	Washer for Filter SMC	<b>C0337</b>	Hose Air M1/8"-F1/4" 500mm
<b>C0170</b>	Seeger d=15mm	<b>C0338</b>	Capacitor 115V T 2134 145-174 MFD
<b>C0171</b>	Kit for Grounding	<b>C0339</b>	Tube Nylon 8/6mm
<b>C0180</b>	Power Cord 115V Am.-Plug 2000mm	<b>C0340</b>	Switch Pressure 4-P 115V/230V
<b>C0200</b>	Switch Pressure 1-P 230V		MDR 21-EA/11 UL-approved
<b>C0202</b>	Valve Head-Pressure Release	<b>C0340-1</b>	Cover Switch Pressure C0340
<b>C0205</b>	Fitting Reduction M1/4"-F1/8"	<b>C0349</b>	Spring for Overload
<b>C0209</b>	Cable Electric 700mm	<b>C0354</b>	Drain-Cock tanktop
<b>C0210</b>	Cable Electric 500mm	<b>C0356</b>	Hose Plastic blue, elastic
<b>C0219</b>	Kit Terminal Box T 2134 A, 115V	<b>C0357</b>	Fitting "L" F1/8"-F1/8"
<b>C0220</b>	Kit Terminal Box T 2134 A, 230V	<b>C0358</b>	Oil-Level Indicator 1/2" Metal Frame
<b>C0223</b>	Pump Compressor 230V T 2134	<b>C0364</b>	Bolt and Nut for Closing Band
<b>C0241XX</b>	Tank 50 lt. horizontal	<b>C0383XX</b>	Tank 24lt. horizontal
<b>C0284XX</b>	Pump Compressor T 2134 A 115V	<b>C0390</b>	Pin for Wheel
<b>C0286</b>	Washer 8,5x15mm UNI 3703	<b>C0394XX</b>	Tank 50-6
<b>C0293</b>	Hose Air F1/8"-F1/8" 300mm	<b>C0437XX</b>	Tank 24lt 100/24 10CE D200
<b>C0306</b>	Kit for Spring-Clamp	<b>C0451</b>	Cable Electric 115V 600mm
<b>C0308</b>	Kit Motor-Parts cpl. 230V w/o Housing	<b>C0453</b>	Fitting Reduction M1/4"-F1/8"
<b>C0309</b>	Bolt for Cover	<b>C0454XX</b>	Plate for Mounting Compressor Pumps
<b>C0310</b>	Pressure-Pipe	<b>C0454XX</b>	Pump Compressor 115V T2134
<b>C0461XX</b>	<b>Housing</b>	<b>C0661</b>	<b>Nut M5 UNI 5567</b>
<b>C0505</b>	<b>Gauge Pressure 1/4" 10 Bar</b>	<b>C0784</b>	<b>Fitting Reduction M1/2"-F3/8"</b>
<b>C0509</b>	<b>Fitting L M1/4"-F1/4"</b>	<b>C0884</b>	<b>Fitting Reduction F3/8"-M1/4"</b>
<b>C0516</b>	<b>Fitting Reduction M3/8"-F1/4"</b>	<b>C0889</b>	<b>Fitting 5-ways Distributor 2xF1/4" and 3x F1/8"</b>
<b>C0517</b>	<b>Plug Drain M 1"</b>		
<b>C0522</b>	<b>Washer 1"</b>	<b>C0895</b>	<b>Wheel Rubber d=80x25mm</b>
<b>C0526</b>	<b>Fitting M1/4"-M1/4"</b>	<b>C0921</b>	<b>Hose Air M1/8"-F1/4" 650mm</b>
<b>C0528</b>	<b>Fitting Reduction M3/4"-F3/8"</b>	<b>C1094XX</b>	<b>Tank 24lt vertical</b>
<b>C0530</b>	<b>Plug M1/2"</b>	<b>C1099</b>	<b>Oil-Level Indicator Plastic 1/2"</b>
<b>C0538</b>	<b>Plug M1/8"</b>	<b>C1235</b>	<b>Kit Valve Plate T 2134 A cpl. with Gaskets</b>
<b>C0567</b>	<b>Fitting M1/8"-M1/8"</b>	<b>B0714</b>	<b>Bolt M8x50mm UNI 5739 ZB</b>
<b>C0583</b>	<b>Foot Rubber d=25mm</b>	<b>R0103</b>	<b>Retaining Ring A-10 outside</b>
<b>C0643</b>	<b>Valve Head Pressure Release</b>	<b>R0153</b>	<b>Bolt M8x25mm UNI 5739</b>
<b>C0659</b>	<b>Bolt TC M5x14mm</b>		



# VAL-AIR 100/24V (T2134A)

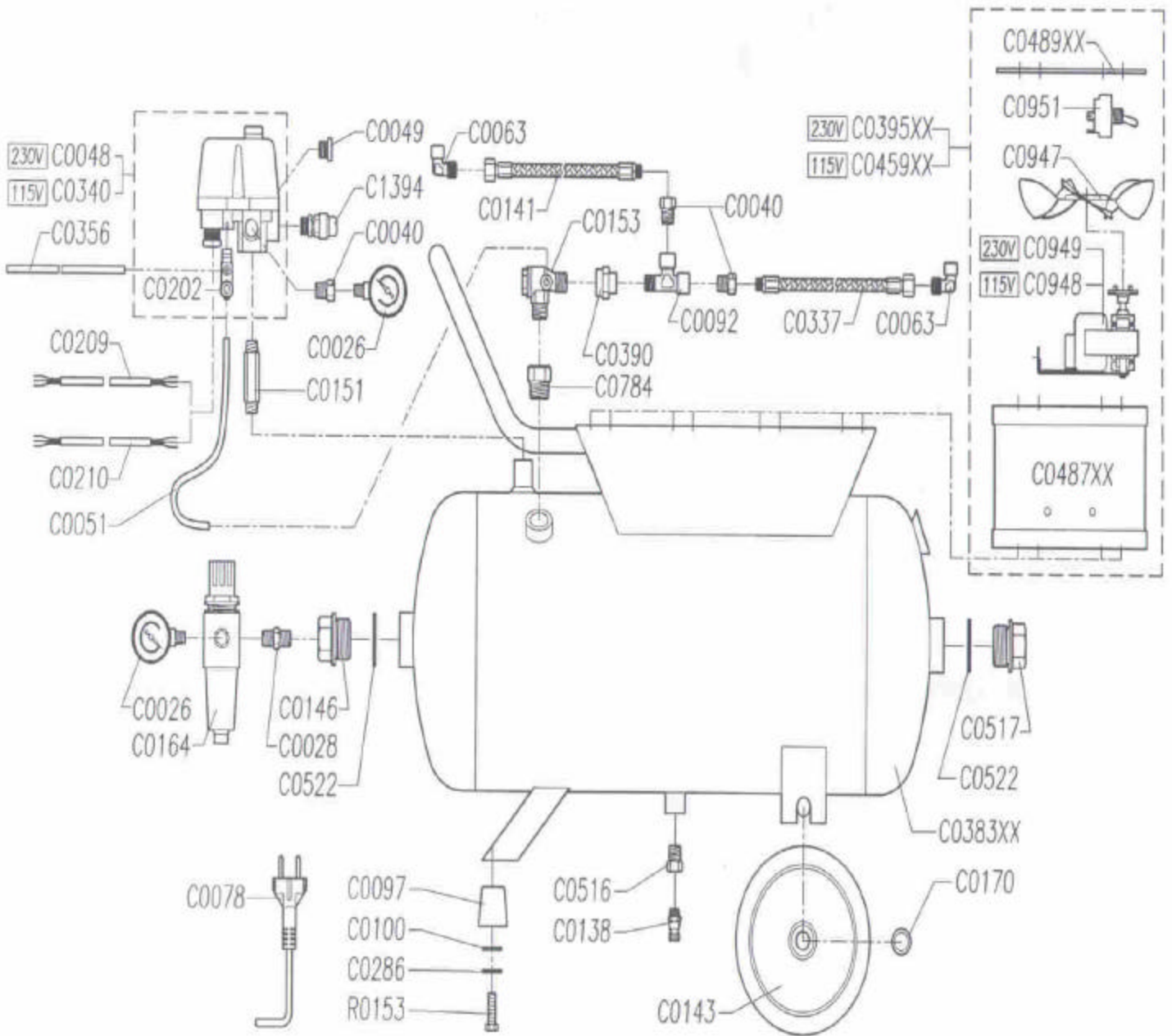

# VAL-AIR 150\50v (T2134A)

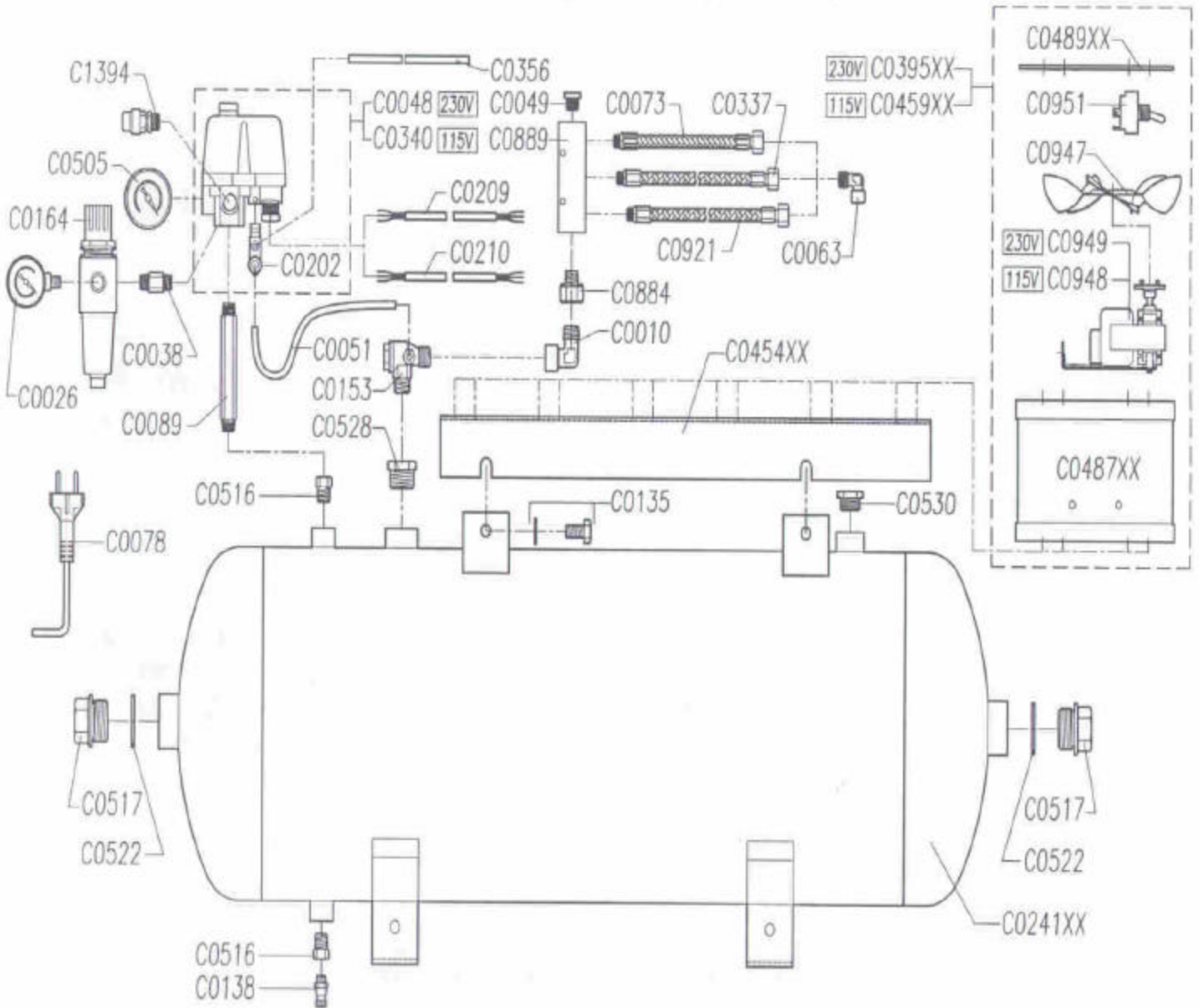

# Compressor Pump T2134A+AL

