



Varsity Task Chair

Assembly Instructions

For model CH112

Parts Included:

KEY	QTY	DESCRIPTION	KEY	QTY	DESCRIPTION	KEY	QTY	DESCRIPTION
1	5	Casters	7	1	Backrest	13	1	Seat Depth Adj. Knob + Washers
2	1	Base	8	1	Backrest Post + Cover	14	6	Seat Plate Screws
3	1	Gas Cylinder	9	1	Plastic Cover	15	1	Allen Wrench M5
4	1	Cylinder Cover	10	1	Steel Plate			
5	1	Seat Plate	11	1	Plastic Bracket			
6	1	Seat	12	2	Backrest Screws			

To Assemble:

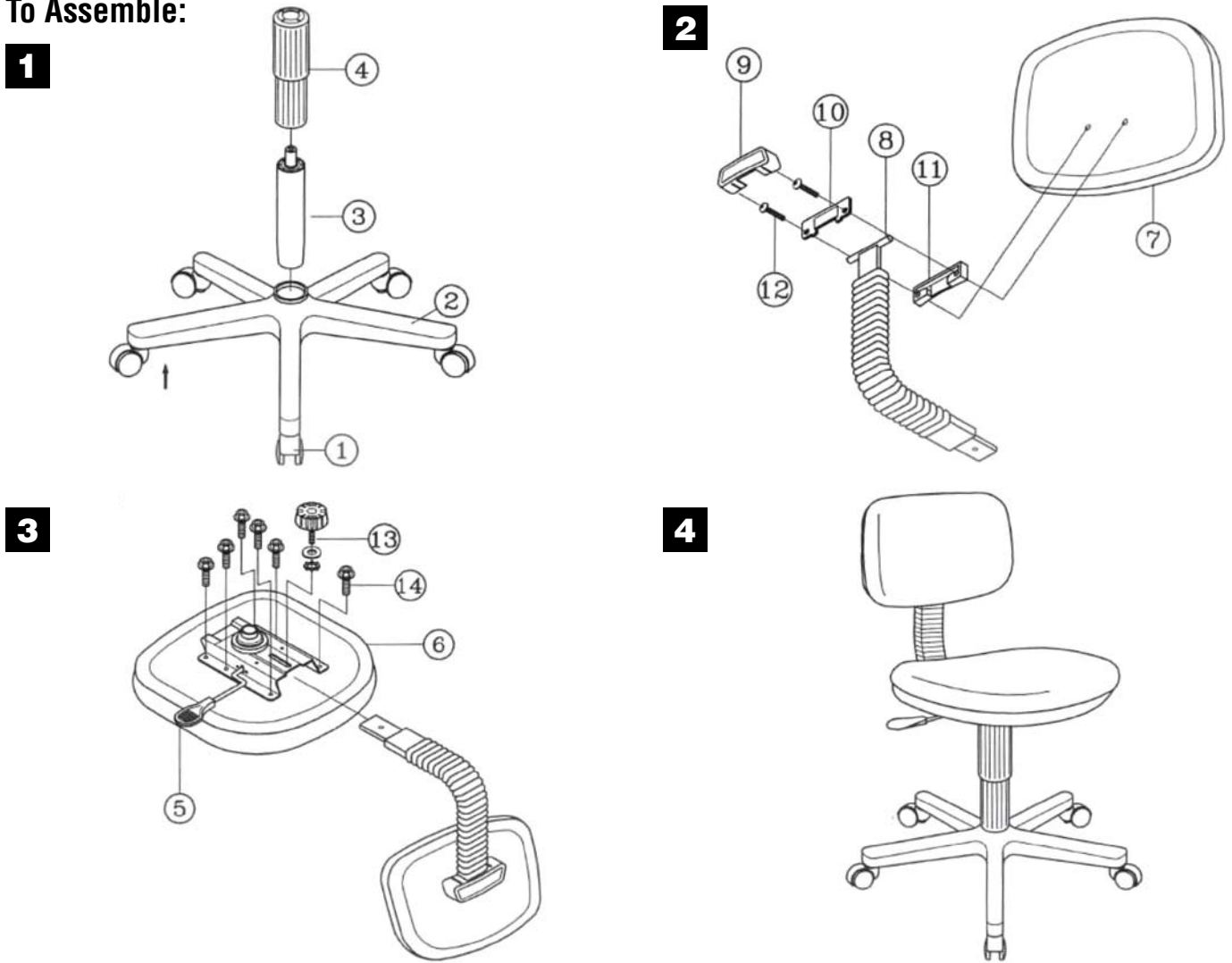

PREVENTIVE MAINTENANCE AND WARNING!

- USE THIS PRODUCT ONLY FOR SEATING ONE PERSON AT A TIME.
- DO NOT USE THIS CHAIR AS A STEP STOOL / LADDER.
- DO NOT SIT ON ANY PART OF THE CHAIR EXCEPT THE SEAT.
- DO NOT USE CHAIR ON UNEVEN FLOOR SURFACES.
- DO NOT USE CHAIR UNLESS ALL BOLTS, SCREWS AND KNOBS ARE TIGHT. AT LEAST EVERY SIX MONTHS, CHECK ALL BOLTS, SCREWS AND KNOBS TO BE SURE THEY ARE TIGHT.
- IF ANY PARTS ARE MISSING, BROKEN, DAMAGED OR WORN, STOP USE OF THE PRODUCT UNTIL REPAIRS ARE MADE USING FACTORY AUTHORIZED PARTS.
- DISPOSE OF PACKAGING PROPERLY. PLASTIC BAG IS NOT A TOY. DO NOT USE PLASTIC BAG AS HEAD COVERING - IT MAY CAUSE SUFFOCATION.
- FAILURE TO FOLLOW THESE WARNINGS COULD RESULT IN SERIOUS INJURY.

WARNING: Serious injury could be caused by one or more of the following: Installation not in strict accordance with the instructions enclosed, misuse by purchaser/user, purchaser/user damage or misuse to or of any included parts, use of product not in accordance with its intended purpose, recklessness, sudden swaying, shifting, or weight change while chair is in use.